



SUBJECT

Ecology



LESSON TOPIC

What is created from waste?



GRADE

16-18 years old



TOOL

Ankiapp



ACTIVITY

Fiche to test knowledge in the area of waste types, segregation, types of recyclables, eco-labels.



RESOURCES: Information on the breakdown of waste, its separation, the extraction of recyclable materials from it and eco-labels on packaging to consolidate knowledge from the previous lesson. Useful links can be found in the 'Resources' section of the pedagogical sequence n° 13.





STEPS – GETTING STARTED

1. Go to the website: Ankiapp and download the software to your PC/phone.
2. Open the Ankiapp software on your computer and click 'SIGN UP' to register and create an account with your email:

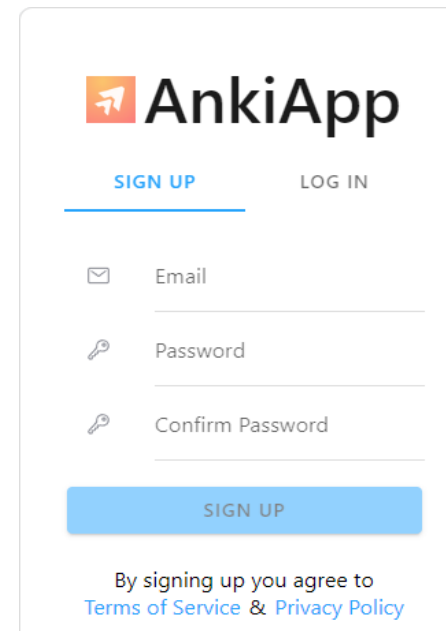
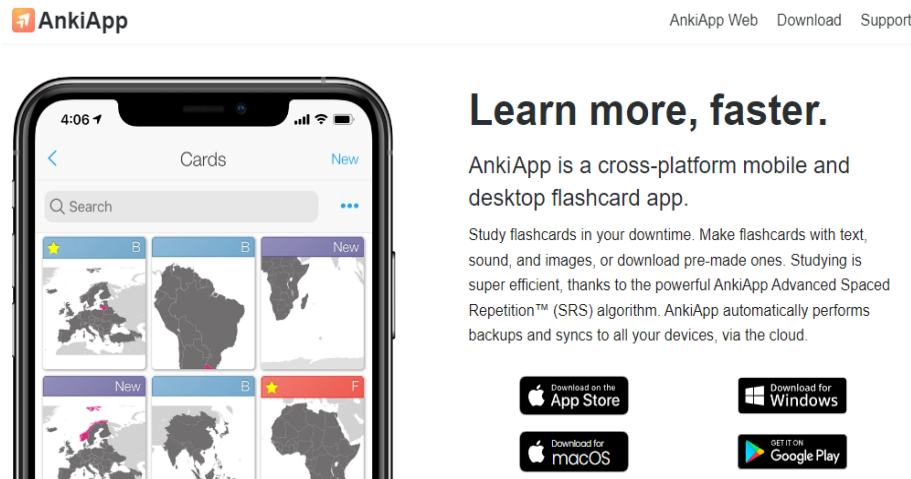

**PREPARE THE ACTIVITY**

1. Review the functions of the application, and on the last slide click 'Start studying'

Start studying



Begin

2. To create a new set of fiches go to 'Decks' and then click on the 'NEW' button in the top right corn.

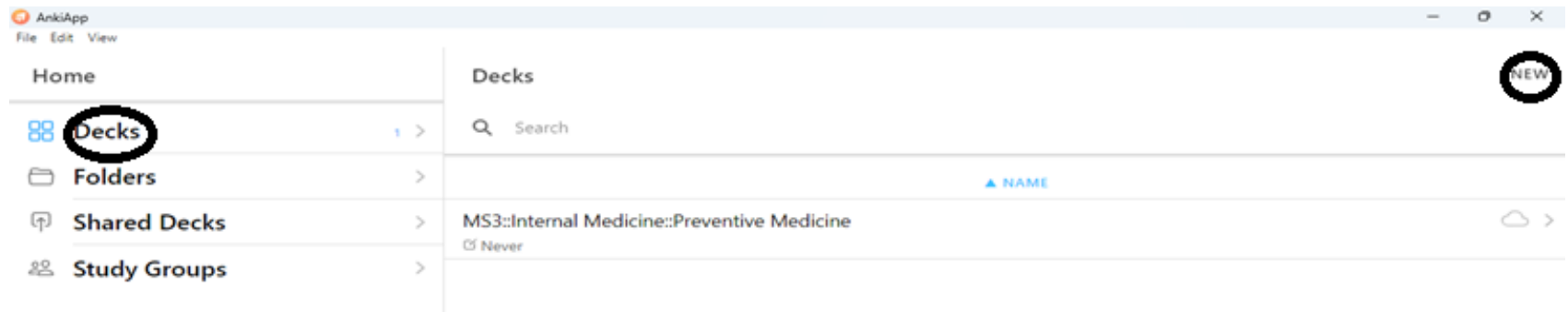

3. Create a new deck by entering the name of the deck.
4. Choose a fiche format.

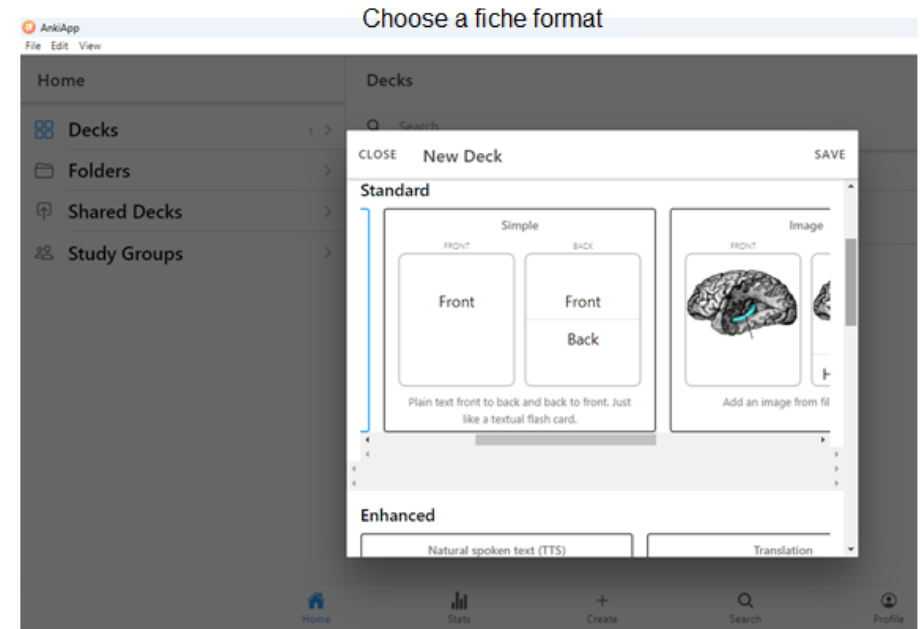
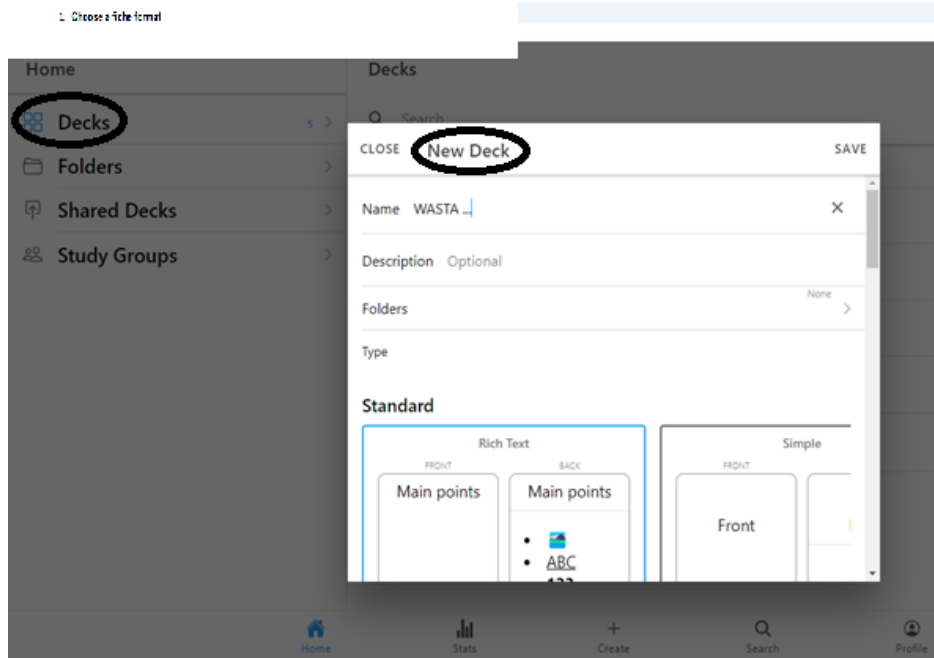

5. Once you have typed in the name of the fiche deck and selected the format, press the 'SAVE' button.
6. To create a new card for the deck go to 'create' located in the bottom toolbar



7. Creation of new cards

- Then press the 'New Card'

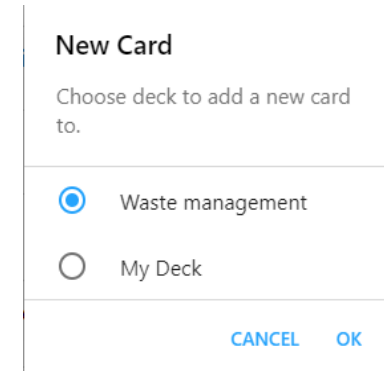
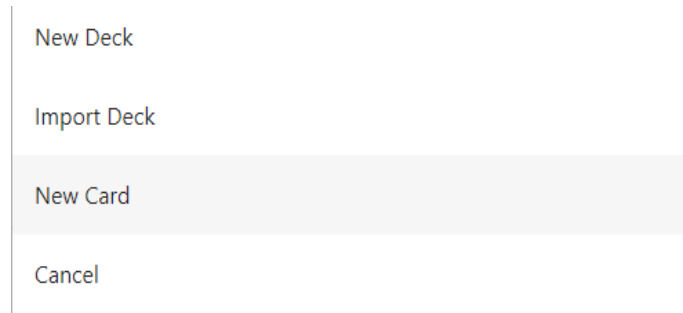

- Once you have selected the name of the deck in which you will be creating cards, click 'OK'

- After selecting the image file, entering the card question, 'Text under image' and the answer text 'Text', click 'SAVE'

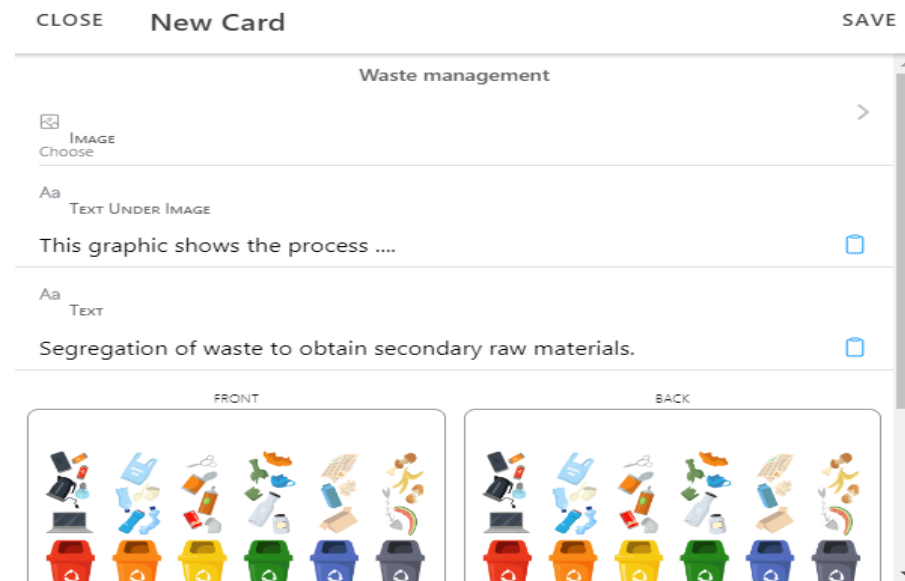

AnkiApp
File Edit View

← DECKS Waste management

66% D

Grade

Grade	Count
New	2
F	0
E	2
D	1
C	6
B	0
A	0

Reviews Today	0
Reviews per Day (Average)	18
Total Number of Reviews	18
Total Review Time	0:04:25
Average Review Time	14.7s

Day	Reviews
Wed	0
Thu	0
Fri	0
Sat	18
Sun	0
Today	0

11/11

Cards

New

C

What are the

C

This graphic

C

The type of

C

The type of

D

E

C

C

EU Ecolabel

→

Review

8. To start learning with the created fiches click at the bottom of the page 'REVIEW'.



SAVE AND PUBLISH

1. To share the deck of created phishes, click the three dots in the upper right corner.
2. Click "SHARE" and when a new window appears, add the name of the study group and the participants in that group by entering their email addresses.
3. After adding the email addresses, click "SHARE".
4. To the e-mail addresses of the participants, will come the information that a deck of "Waste Management" fiches has been made available to them and that this deck will appear in the "Shared decks" section the next time you launch the AnkiApp.
5. Log in or create an account on Ankiapp, then go to the 'Study Groups' section, select your group and then click the 'Shared decks' button and select a deck of fiches. The exact sharing path is presented in the 'ADDITIONAL RESOURCES' section.

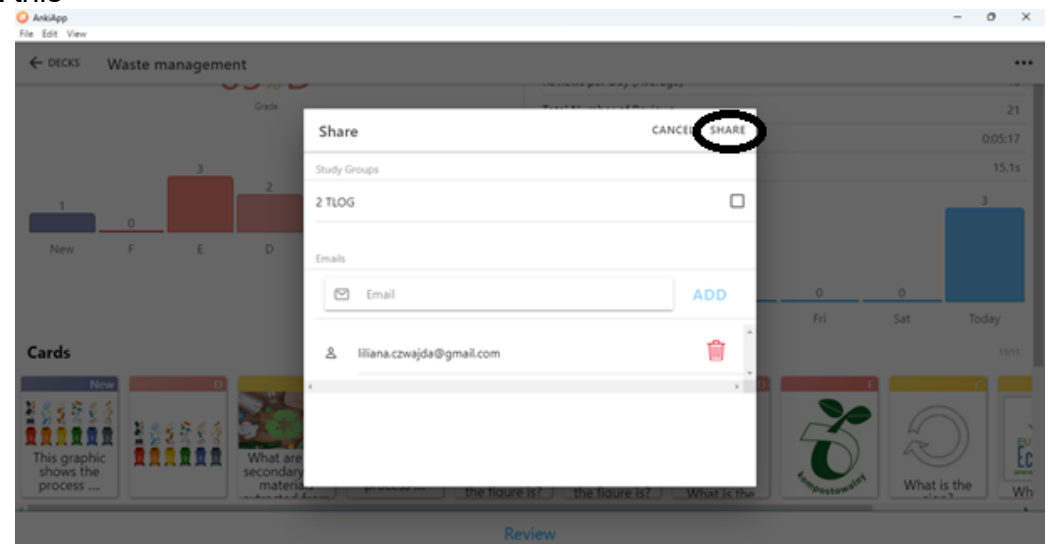
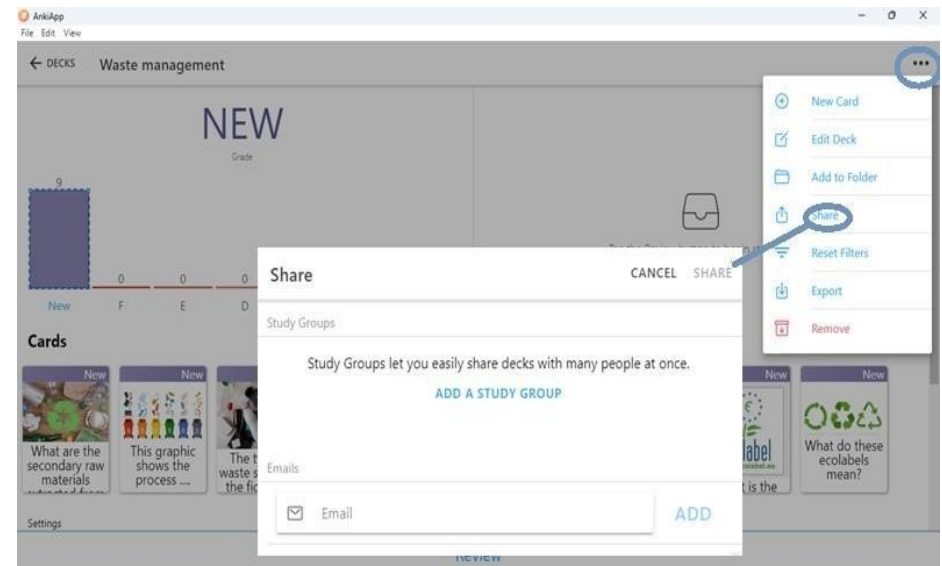

ADDITIONAL RESOURCES

The screenshot shows the AnkiApp interface with two windows. The left window is the 'Home' screen with a sidebar menu containing 'Decks', 'Folders', 'Shared Decks', and 'Study Groups'. The 'Study Groups' item is circled in black, and an arrow points from it to the '2 TLOG' group in the 'Study Groups' window. The 'Study Groups' window shows a search bar and a list of groups, with '2 TLOG' circled in black. An arrow points from '2 TLOG' to the 'Shared Decks' section in the '2 TLOG' window. The 'Shared Decks' section contains a deck named 'waste management', which is circled in black. An arrow points from 'waste management' to the 'Review' button at the bottom of the screen, which is also circled in black. The 'Review' button is highlighted in blue. The '2 TLOG' window also displays a progress bar and a bar chart showing the number of cards reviewed over the last four days (Thu, Fri, Sat, Today).